

Outer Steel Wire Hose

Order Code

PST-6-D-D-0.8-T-S



4	Φ4 fittings				N	(None) standard
6	Φ6 fittings				S	Custom materials
D	Left KD straight fitting				N	No spring sheath
H	Left KH elbow fitting				T	With spring sheath
D	Right KD straight fitting				X	Length (m)
H	Right KH elbow fitting					

1. It is composed of a braided hose and a crimping joint.
2. The braided hose is made of three layers: inner lining rubber, middle reinforcing wire fiber, and outer braided mesh.
3. It is suitable for occasions where the lubrication points of mechanical equipment parts have relative movement. The applicable temperature range is -40°C~80°C.

Specification

Model	d(mm)	Maximum pressure	Min bending radius	Length(m)
PST-4	Φ4	10 MPa	R20	Customization
PST-6	Φ6	15 MPa	R40	Customization

Dimension

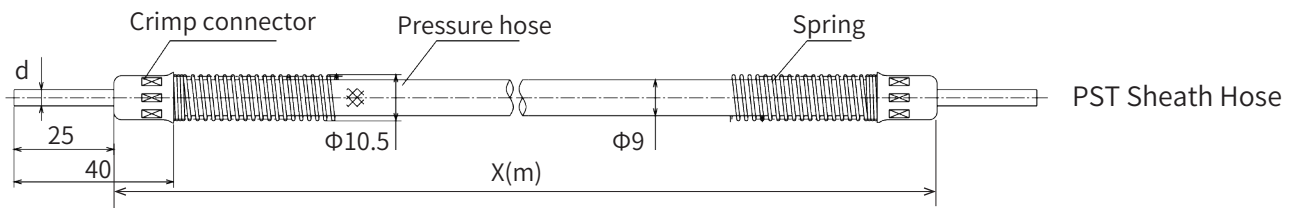

Nylon Tube Sheath



Model	Inner diameter	ID x length	N.W(g)
NPS-42000	Φ4.5	Φ4.5x2000mm	95
NPS-44000	Φ4.5	Φ4.5x4000mm	190
NPS-62000	Φ6.5	Φ6.5x2000mm	160
NPS-64000	Φ6.5	Φ6.5x4000mm	320

Bushing

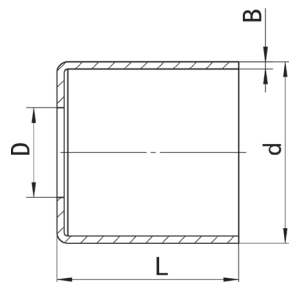

Molde	D(mm)	d(mm)	L(mm)	B(mm)
HT-4	4.5	6.9	8	0.5
HT-6	6.2	8.9	12	0.5
HT-8	7.2	12.2	15	0.8